



Roskill Development

PUT YOURSELF IN THE CENTRE

2 February 2022

Owner/Occupant
1/128A
Hendon Avenue
Mount Albert, Auckland 1025

Kia ora neighbour

New housing for Hendon Ave 130 & 132

As you are aware, Kāinga Ora (formerly Housing New Zealand) is intending to redevelop its land at Hendon Ave 130 & 132. We are now writing to advise that Auckland Council has granted resource consent for the development.

Our intention is to better utilise land currently occupied by a small number of old houses on large sections. We will do this by building a greater variety of new, warm, healthy homes, designed to complement the local environment and meet the needs of today's tenants.

The redevelopment at this location will see 2 old homes replaced with 10 warm, dry, modern homes. These will be made up of:

- 10 x two-bedroom

A site plan and landscape plan are enclosed. We will be in touch with construction details once confirmed with our build partner.

If you have any questions or concerns about any of the Kāinga Ora sites, please get in touch via email or contact phone below and ask to speak to a Community Development & Engagement Co-ordinator or a Stakeholder Relationship Manager in the Central East Auckland Team.

For wider Roskill Development queries, please contact info@roskilldevelopment.co.nz or visit www.roskilldevelopment.co.nz

Nāku iti noa, noa

Community Engagement and Partnerships Team

Central East Auckland

Freephone: 0800 801 601
Email: centraleastakl.region@kaingaora.govt.nz



Roskill Development
PUT YOURSELF IN THE CENTRE



Kāinga Ora
Homes and Communities

Figure1: Site Plan

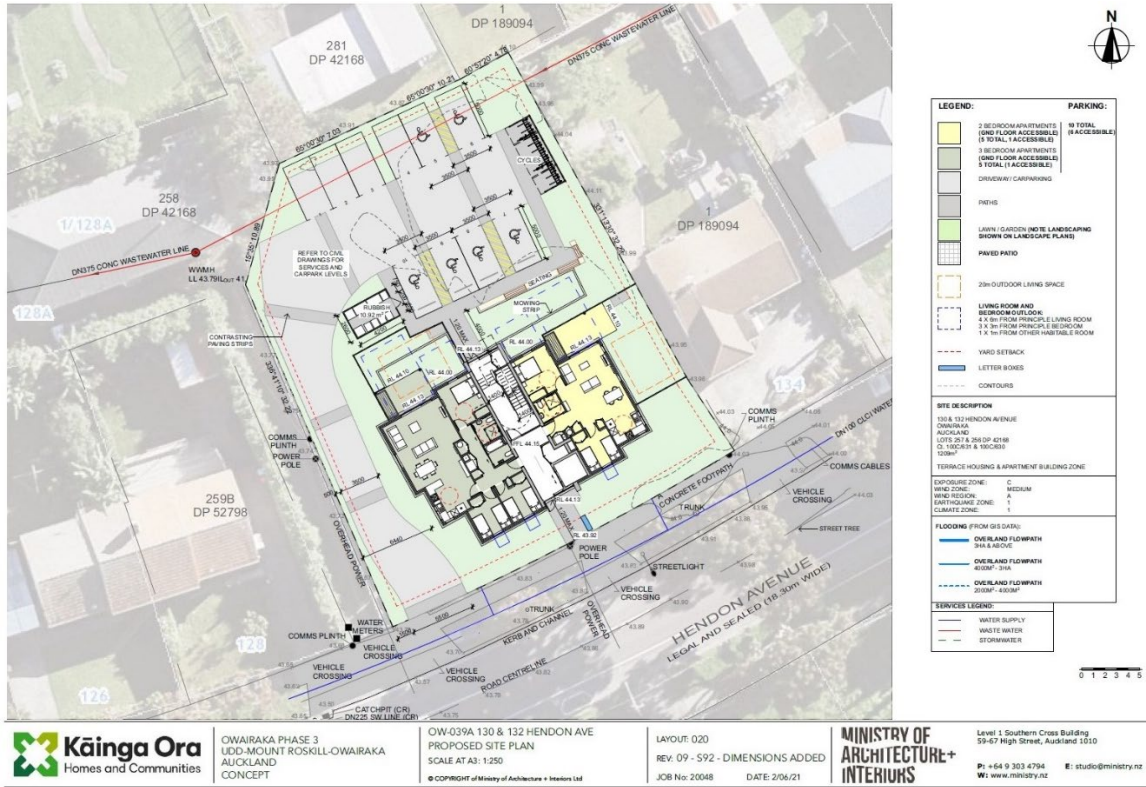

Figure 2: Landscape Plan





Roskill Development

PUT YOURSELF IN THE CENTRE

2 February 2022

Owner/Occupant
2/128A
Hendon Avenue
Mount Albert, Auckland 1025

Kia ora neighbour

New housing for Hendon Ave 130 & 132

As you are aware, Kāinga Ora (formerly Housing New Zealand) is intending to redevelop its land at Hendon Ave 130 & 132. We are now writing to advise that Auckland Council has granted resource consent for the development.

Our intention is to better utilise land currently occupied by a small number of old houses on large sections. We will do this by building a greater variety of new, warm, healthy homes, designed to complement the local environment and meet the needs of today's tenants.

The redevelopment at this location will see 2 old homes replaced with 10 warm, dry, modern homes. These will be made up of:

- 10 x two-bedroom

A site plan and landscape plan are enclosed. We will be in touch with construction details once confirmed with our build partner.

If you have any questions or concerns about any of the Kāinga Ora sites, please get in touch via email or contact phone below and ask to speak to a Community Development & Engagement Co-ordinator or a Stakeholder Relationship Manager in the Central East Auckland Team.

For wider Roskill Development queries, please contact info@roskilldevelopment.co.nz or visit www.roskilldevelopment.co.nz

Nāku iti noa, noa

Community Engagement and Partnerships Team
Central East Auckland

Freephone: 0800 801 601
Email: centraleastakl.region@kaingaora.govt.nz



Roskill Development
PUT YOURSELF IN THE CENTRE



Kāinga Ora
Homes and Communities

Figure1: Site Plan

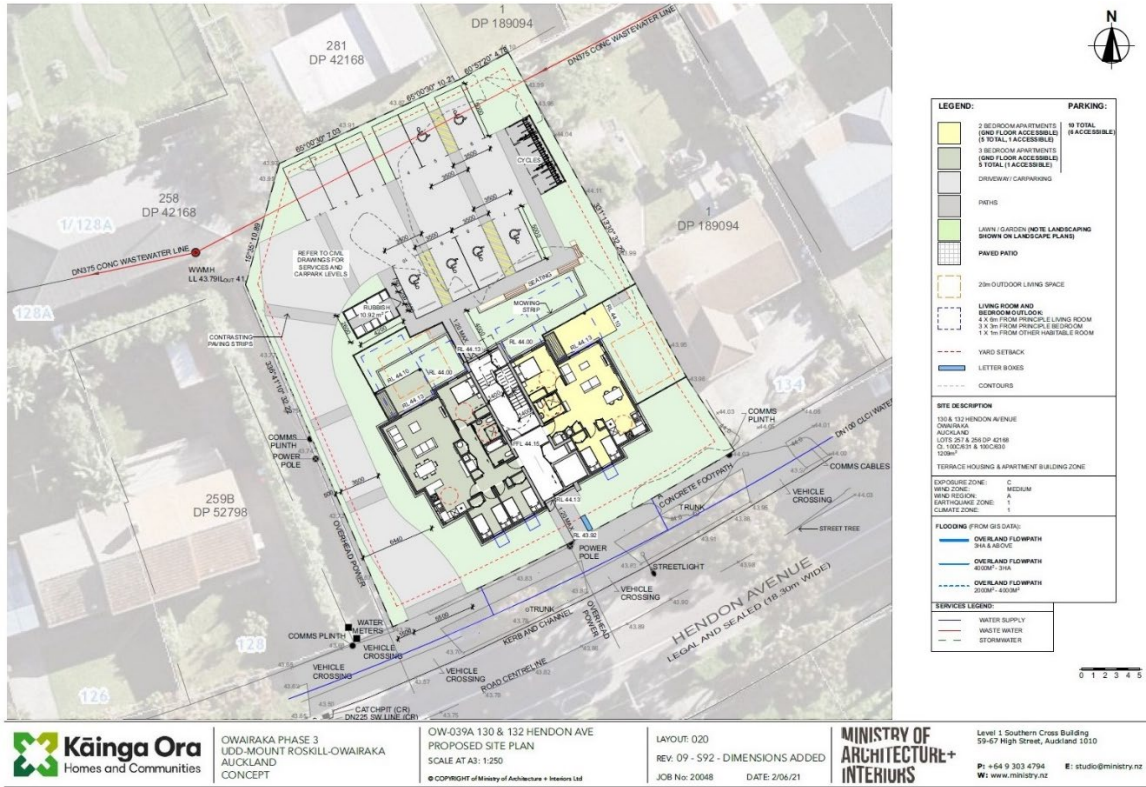



Roskill Development

PUT YOURSELF IN THE CENTRE

2 February 2022

Owner/Occupant
3/128A
Hendon Avenue
Mount Albert, Auckland 1025

Kia ora neighbour

New housing for Hendon Ave 130 & 132

As you are aware, Kāinga Ora (formerly Housing New Zealand) is intending to redevelop its land at Hendon Ave 130 & 132. We are now writing to advise that Auckland Council has granted resource consent for the development.

Our intention is to better utilise land currently occupied by a small number of old houses on large sections. We will do this by building a greater variety of new, warm, healthy homes, designed to complement the local environment and meet the needs of today's tenants.

The redevelopment at this location will see 2 old homes replaced with 10 warm, dry, modern homes. These will be made up of:

- 10 x two-bedroom

A site plan and landscape plan are enclosed. We will be in touch with construction details once confirmed with our build partner.

If you have any questions or concerns about any of the Kāinga Ora sites, please get in touch via email or contact phone below and ask to speak to a Community Development & Engagement Co-ordinator or a Stakeholder Relationship Manager in the Central East Auckland Team.

For wider Roskill Development queries, please contact info@roskilldevelopment.co.nz or visit www.roskilldevelopment.co.nz

Nāku iti noa, noa

Community Engagement and Partnerships Team

Central East Auckland

Freephone: 0800 801 601
Email: centraleastakl.region@kaingaora.govt.nz



Roskill Development
PUT YOURSELF IN THE CENTRE

 **Kāinga Ora**
Homes and Communities

Figure1: Site Plan

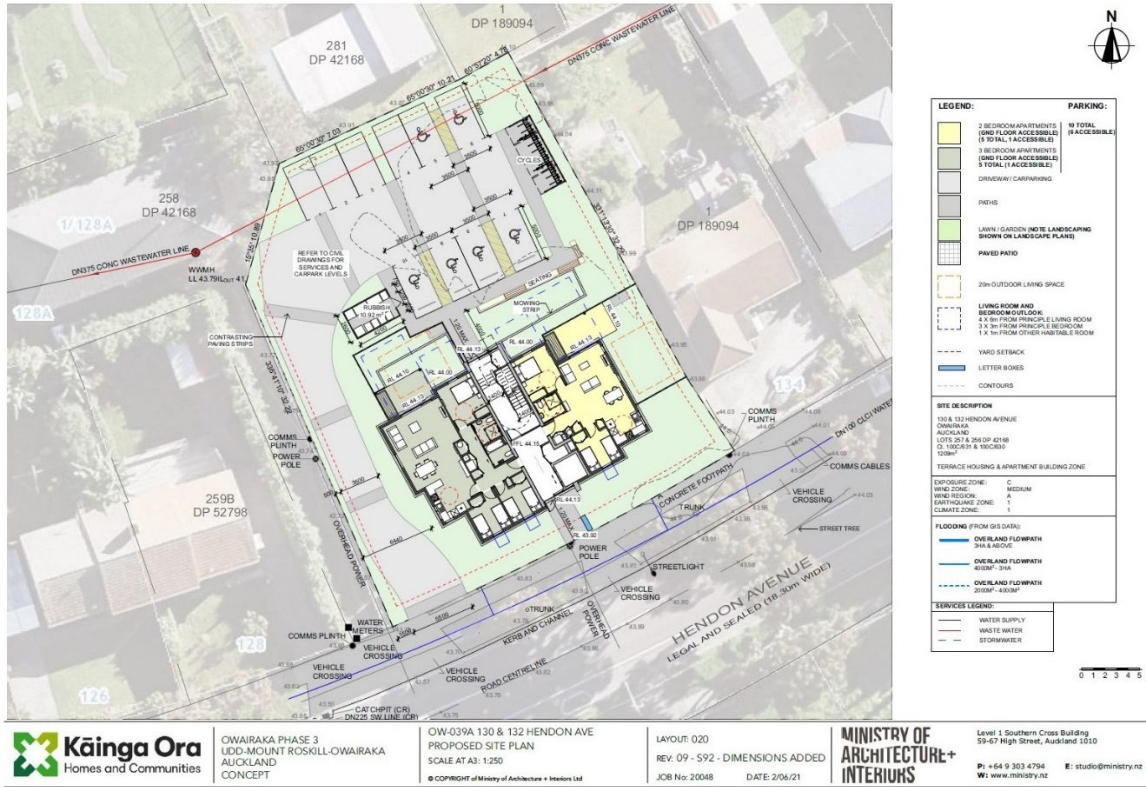

Figure 2: Landscape Plan





Roskill Development

PUT YOURSELF IN THE CENTRE

2 February 2022

Owner/Occupant
128A
Hendon Avenue
Mount Albert, Auckland 1025

Kia ora neighbour

New housing for Hendon Ave 130 & 132

As you are aware, Kāinga Ora (formerly Housing New Zealand) is intending to redevelop its land at Hendon Ave 130 & 132. We are now writing to advise that Auckland Council has granted resource consent for the development.

Our intention is to better utilise land currently occupied by a small number of old houses on large sections. We will do this by building a greater variety of new, warm, healthy homes, designed to complement the local environment and meet the needs of today's tenants.

The redevelopment at this location will see 2 old homes replaced with 10 warm, dry, modern homes. These will be made up of:

- 10 x two-bedroom

A site plan and landscape plan are enclosed. We will be in touch with construction details once confirmed with our build partner.

If you have any questions or concerns about any of the Kāinga Ora sites, please get in touch via email or contact phone below and ask to speak to a Community Development & Engagement Co-ordinator or a Stakeholder Relationship Manager in the Central East Auckland Team.

For wider Roskill Development queries, please contact info@roskilldevelopment.co.nz or visit www.roskilldevelopment.co.nz

Nāku iti noa, noa

Community Engagement and Partnerships Team
Central East Auckland

Freephone: 0800 801 601
Email: centraleastakl.region@kaingaora.govt.nz



Figure1: Site Plan

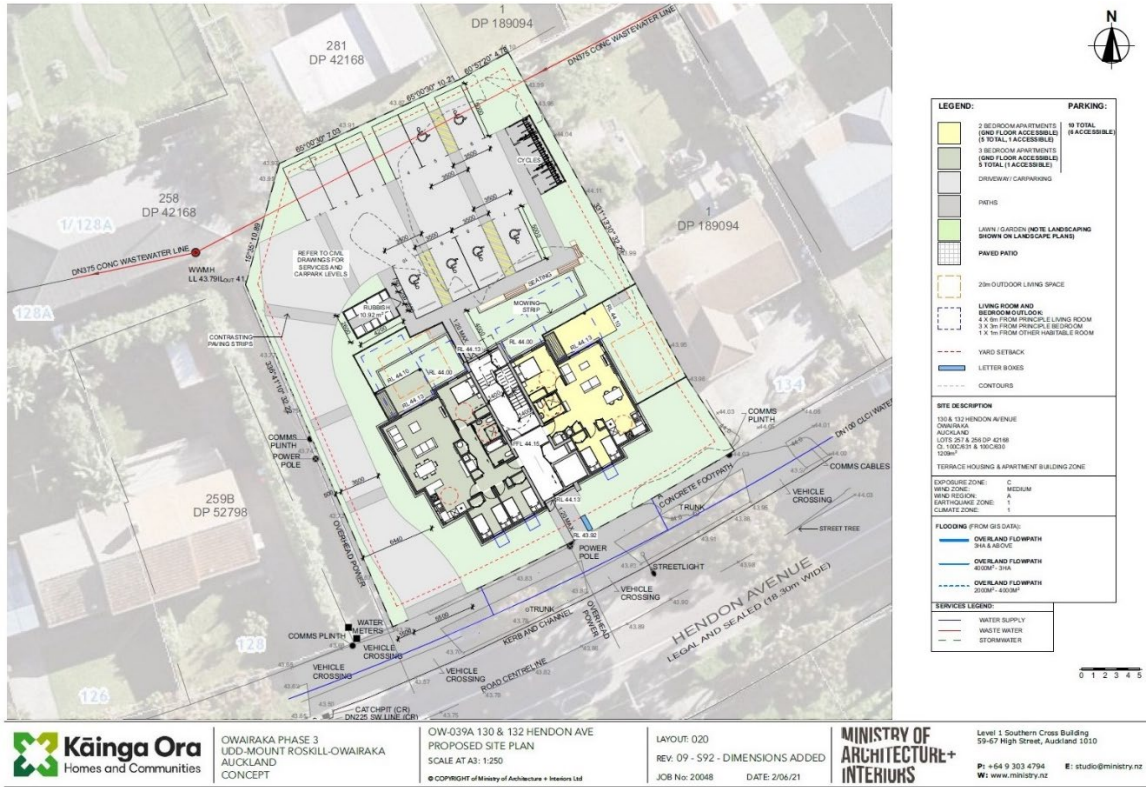

Figure 2: Landscape Plan





Roskill Development

PUT YOURSELF IN THE CENTRE

2 February 2022

Owner/Occupant

27

Hargest Terrace

Mount Albert, Auckland 1025

Kia ora neighbour

New housing for Hendon Ave 130 & 132

As you are aware, Kāinga Ora (formerly Housing New Zealand) is intending to redevelop its land at Hendon Ave 130 & 132. We are now writing to advise that Auckland Council has granted resource consent for the development.

Our intention is to better utilise land currently occupied by a small number of old houses on large sections. We will do this by building a greater variety of new, warm, healthy homes, designed to complement the local environment and meet the needs of today's tenants.

The redevelopment at this location will see 2 old homes replaced with 10 warm, dry, modern homes. These will be made up of:

- 10 x two-bedroom

A site plan and landscape plan are enclosed. We will be in touch with construction details once confirmed with our build partner.

If you have any questions or concerns about any of the Kāinga Ora sites, please get in touch via email or contact phone below and ask to speak to a Community Development & Engagement Co-ordinator or a Stakeholder Relationship Manager in the Central East Auckland Team.

For wider Roskill Development queries, please contact info@roskilldevelopment.co.nz or visit www.roskilldevelopment.co.nz

Nāku iti noa, noa

Community Engagement and Partnerships Team

Central East Auckland

Freephone: 0800 801 601

Email: centraleastakl.region@kaingaora.govt.nz



Roskill Development
PUT YOURSELF IN THE CENTRE



Kāinga Ora
Homes and Communities

Figure1: Site Plan

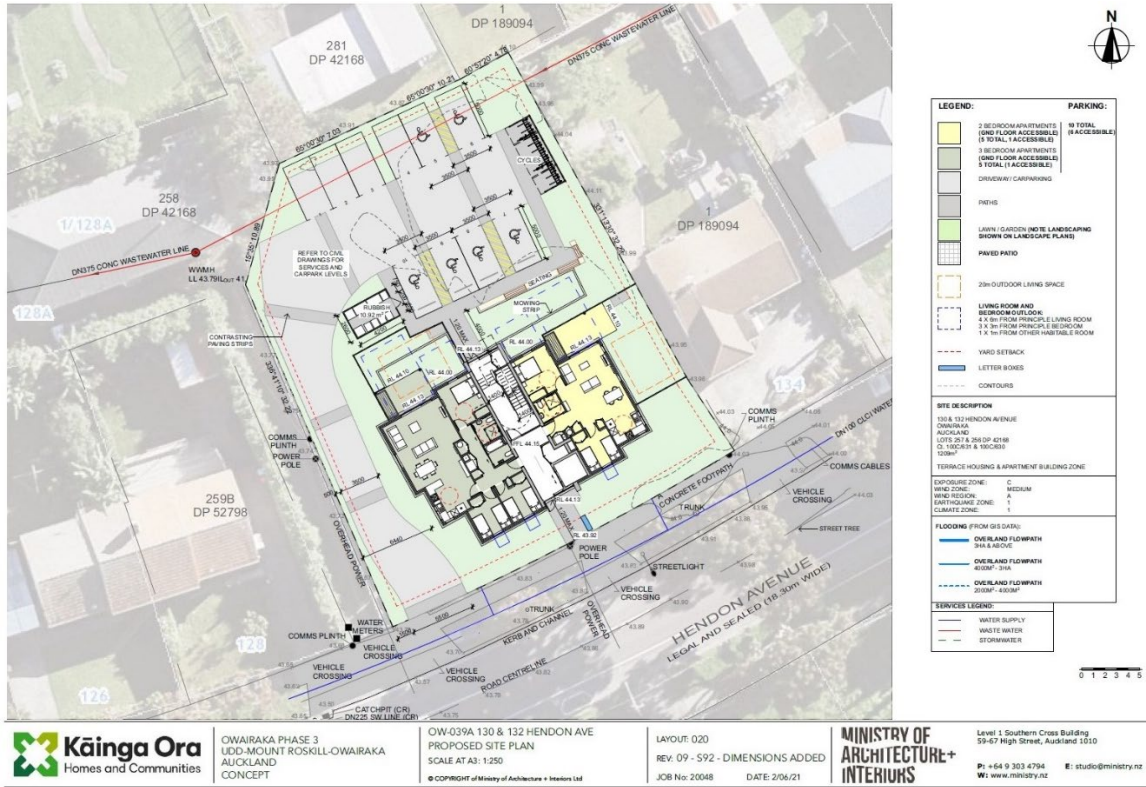

Figure 2: Landscape Plan





Roskill Development

PUT YOURSELF IN THE CENTRE

2 February 2022

Owner/Occupant Wasim Sidyot
134
Hendon Avenue
Mount Albert, Auckland 1025

Kia ora neighbour

New housing for Hendon Ave 130 & 132

As you are aware, Kāinga Ora (formerly Housing New Zealand) is intending to redevelop its land at Hendon Ave 130 & 132. We are now writing to advise that Auckland Council has granted resource consent for the development.

Our intention is to better utilise land currently occupied by a small number of old houses on large sections. We will do this by building a greater variety of new, warm, healthy homes, designed to complement the local environment and meet the needs of today's tenants.

The redevelopment at this location will see 2 old homes replaced with 10 warm, dry, modern homes. These will be made up of:

- 10 x two-bedroom

A site plan and landscape plan are enclosed. We will be in touch with construction details once confirmed with our build partner.

If you have any questions or concerns about any of the Kāinga Ora sites, please get in touch via email or contact phone below and ask to speak to a Community Development & Engagement Co-ordinator or a Stakeholder Relationship Manager in the Central East Auckland Team.

For wider Roskill Development queries, please contact info@roskilldevelopment.co.nz or visit www.roskilldevelopment.co.nz

Nāku iti noa, noa

Community Engagement and Partnerships Team
Central East Auckland

Freephone: 0800 801 601
Email: centraleastakl.region@kaingaora.govt.nz



Roskill Development
PUT YOURSELF IN THE CENTRE

 **Kāinga Ora**
Homes and Communities

Figure1: Site Plan

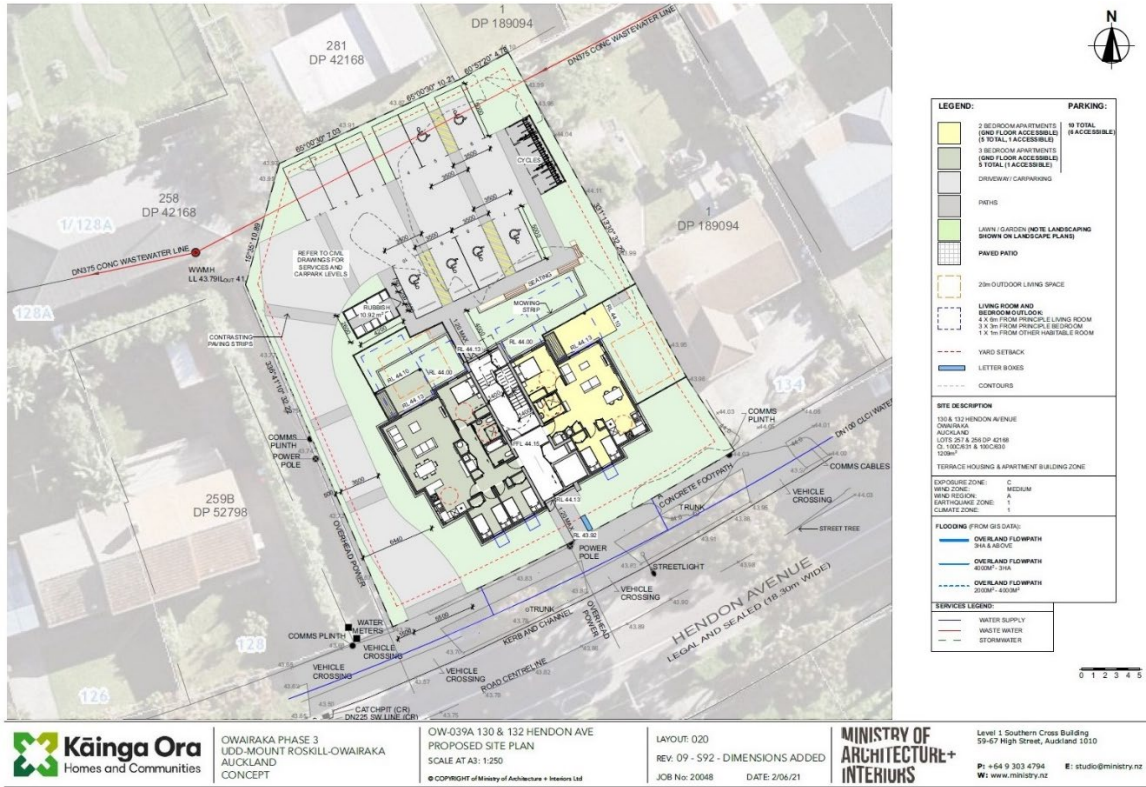

Figure 2: Landscape Plan





Roskill Development

PUT YOURSELF IN THE CENTRE

2 February 2022

Owner/Occupant Eshan & Varun Gupta

2

Barrymore Road

Mount Albert, Auckland 1025

Kia ora neighbour

New housing for Hendon Ave 130 & 132

As you are aware, Kāinga Ora (formerly Housing New Zealand) is intending to redevelop its land at Hendon Ave 130 & 132. We are now writing to advise that Auckland Council has granted resource consent for the development.

Our intention is to better utilise land currently occupied by a small number of old houses on large sections. We will do this by building a greater variety of new, warm, healthy homes, designed to complement the local environment and meet the needs of today's tenants.

The redevelopment at this location will see 2 old homes replaced with 10 warm, dry, modern homes. These will be made up of:

- 10 x two-bedroom

A site plan and landscape plan are enclosed. We will be in touch with construction details once confirmed with our build partner.

If you have any questions or concerns about any of the Kāinga Ora sites, please get in touch via email or contact phone below and ask to speak to a Community Development & Engagement Co-ordinator or a Stakeholder Relationship Manager in the Central East Auckland Team.

For wider Roskill Development queries, please contact info@roskilldevelopment.co.nz or visit www.roskilldevelopment.co.nz

Nāku iti noa, noa

Community Engagement and Partnerships Team

Central East Auckland

Freephone: 0800 801 601

Email: centraleastakl.region@kaingaora.govt.nz



Roskill Development

PUT YOURSELF IN THE CENTRE



Kāinga Ora

Homes and Communities

Figure1: Site Plan

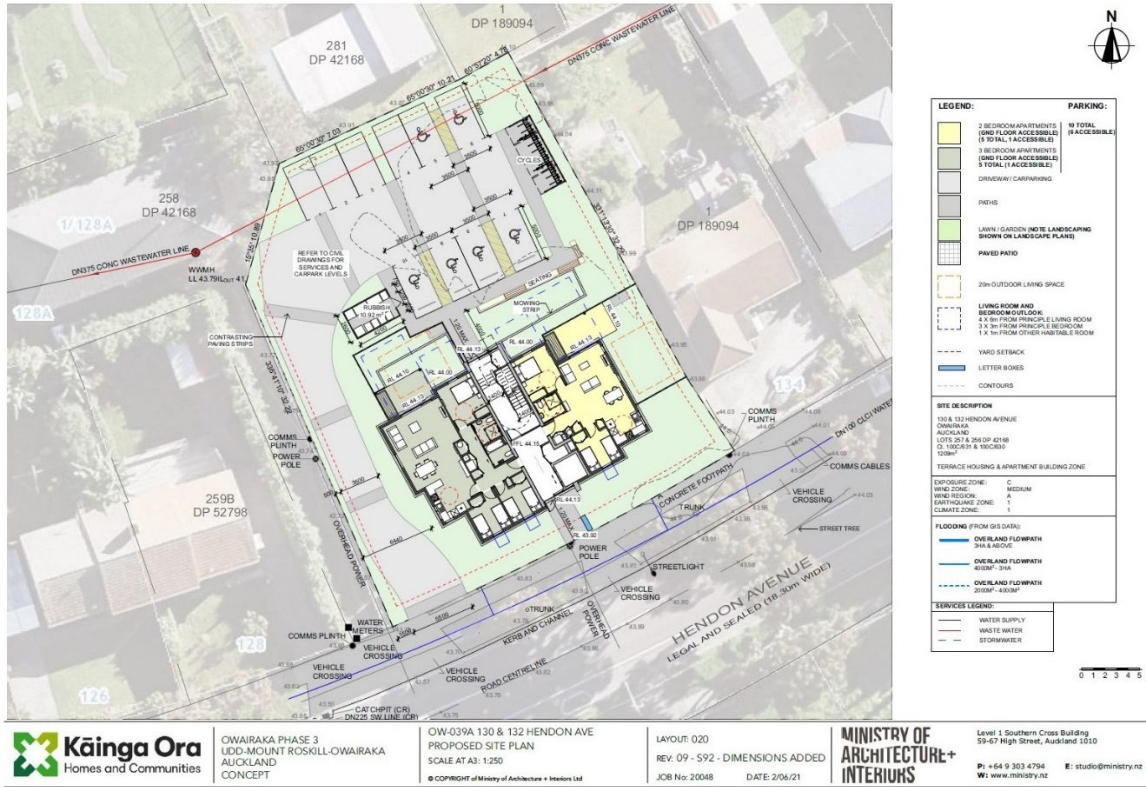

Figure 2: Landscape Plan





Roskill Development

PUT YOURSELF IN THE CENTRE

2 February 2022

Owner/Occupant Jackson Wall
128
Hendon Avenue
Mount Albert, Auckland 1025

Kia ora neighbour

New housing for Hendon Ave 130 & 132

As you are aware, Kāinga Ora (formerly Housing New Zealand) is intending to redevelop its land at Hendon Ave 130 & 132. We are now writing to advise that Auckland Council has granted resource consent for the development.

Our intention is to better utilise land currently occupied by a small number of old houses on large sections. We will do this by building a greater variety of new, warm, healthy homes, designed to complement the local environment and meet the needs of today's tenants.

The redevelopment at this location will see 2 old homes replaced with 10 warm, dry, modern homes. These will be made up of:

- 10 x two-bedroom

A site plan and landscape plan are enclosed. We will be in touch with construction details once confirmed with our build partner.

If you have any questions or concerns about any of the Kāinga Ora sites, please get in touch via email or contact phone below and ask to speak to a Community Development & Engagement Co-ordinator or a Stakeholder Relationship Manager in the Central East Auckland Team.

For wider Roskill Development queries, please contact info@roskilldevelopment.co.nz or visit www.roskilldevelopment.co.nz

Nāku iti noa, noa

Community Engagement and Partnerships Team
Central East Auckland

Freephone: 0800 801 601
Email: centraleastakl.region@kaingaora.govt.nz



Roskill Development
PUT YOURSELF IN THE CENTRE



Kāinga Ora
Homes and Communities

Figure1: Site Plan

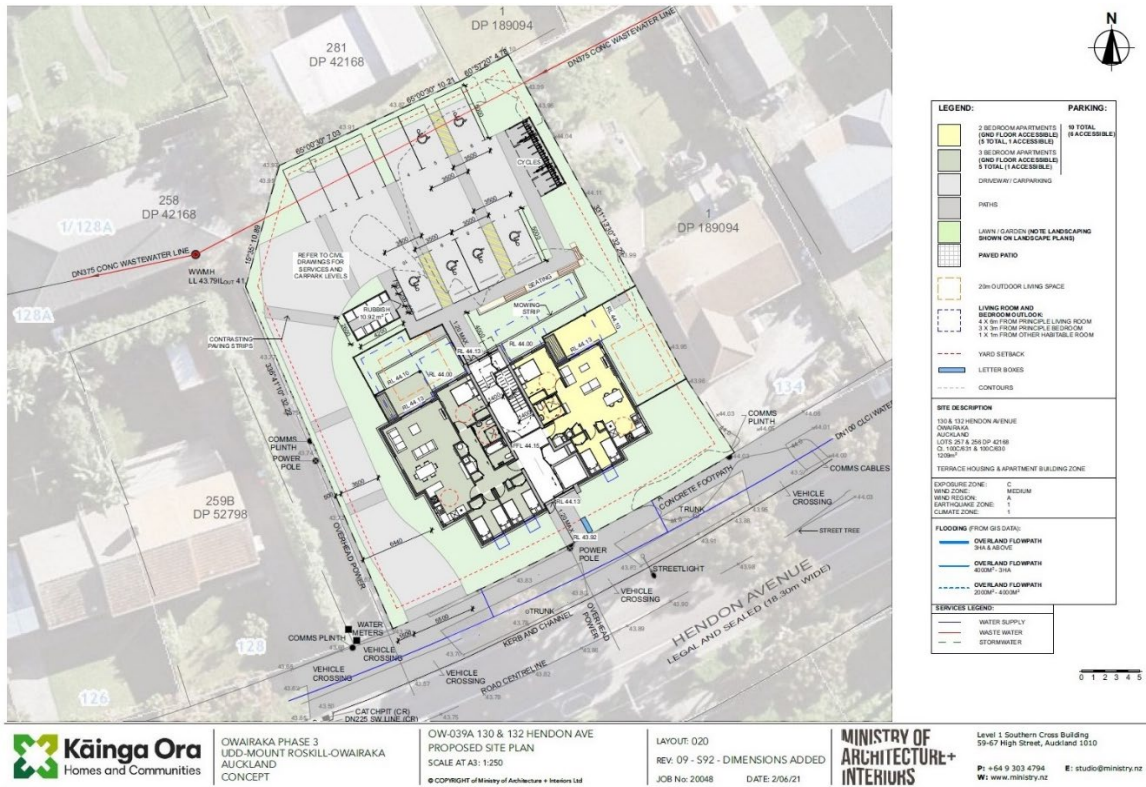

Figure 2: Landscape Plan





Roskill Development

PUT YOURSELF IN THE CENTRE

2 February 2022

Owner/Occupant

1

Barrymore Road

Mount Albert, Auckland 1025

Kia ora neighbour

New housing for Hendon Ave 130 & 132

As you are aware, Kāinga Ora (formerly Housing New Zealand) is intending to redevelop its land at Hendon Ave 130 & 132. We are now writing to advise that Auckland Council has granted resource consent for the development.

Our intention is to better utilise land currently occupied by a small number of old houses on large sections. We will do this by building a greater variety of new, warm, healthy homes, designed to complement the local environment and meet the needs of today's tenants.

The redevelopment at this location will see 2 old homes replaced with 10 warm, dry, modern homes. These will be made up of:

- 10 x two-bedroom

A site plan and landscape plan are enclosed. We will be in touch with construction details once confirmed with our build partner.

If you have any questions or concerns about any of the Kāinga Ora sites, please get in touch via email or contact phone below and ask to speak to a Community Development & Engagement Co-ordinator or a Stakeholder Relationship Manager in the Central East Auckland Team.

For wider Roskill Development queries, please contact info@roskilldevelopment.co.nz or visit www.roskilldevelopment.co.nz

Nāku iti noa, noa

Community Engagement and Partnerships Team

Central East Auckland

Freephone: 0800 801 601

Email: centraleastakl.region@kaingaora.govt.nz



Figure 1: Site Plan

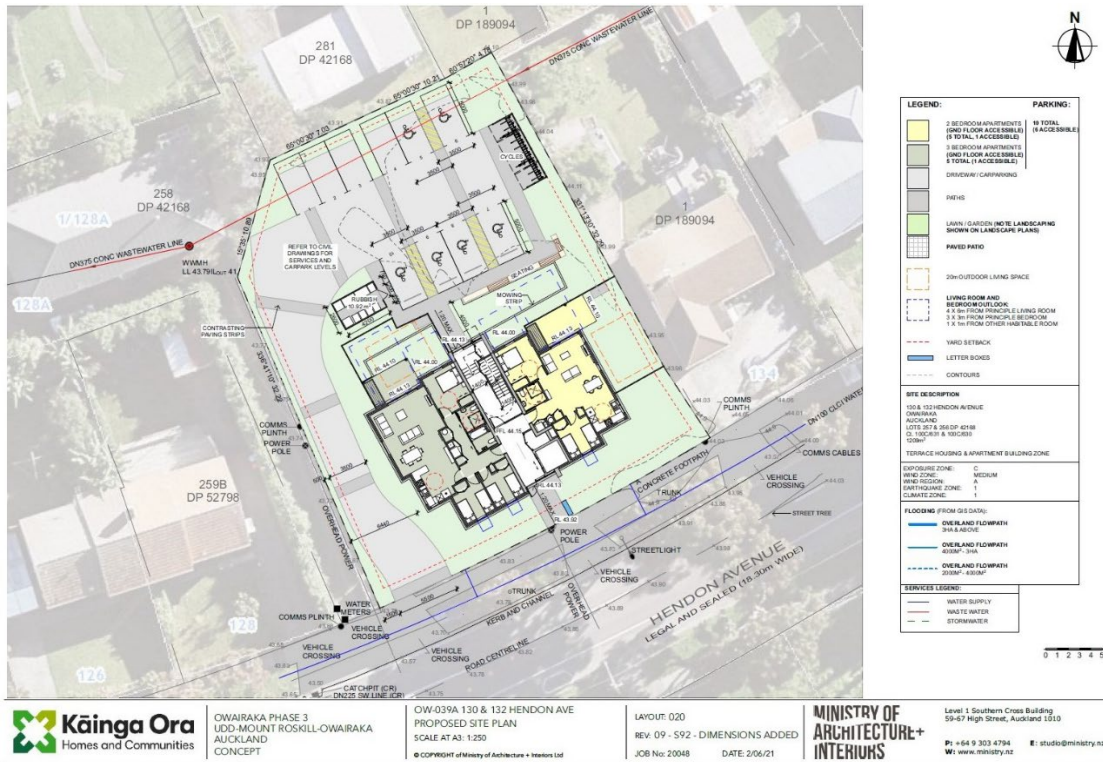

Figure 2: Landscape Plan





Roskill Development

PUT YOURSELF IN THE CENTRE

2 February 2022

Owner/Occupant Ethan McCambridge & Sophia David
143
Hendon Avenue
Mount Albert, Auckland 1025

Kia ora neighbour

New housing for Hendon Ave 130 & 132

As you are aware, Kāinga Ora (formerly Housing New Zealand) is intending to redevelop its land at Hendon Ave 130 & 132. We are now writing to advise that Auckland Council has granted resource consent for the development.

Our intention is to better utilise land currently occupied by a small number of old houses on large sections. We will do this by building a greater variety of new, warm, healthy homes, designed to complement the local environment and meet the needs of today's tenants.

The redevelopment at this location will see 2 old homes replaced with 10 warm, dry, modern homes. These will be made up of:

- 10 x two-bedroom

A site plan and landscape plan are enclosed. We will be in touch with construction details once confirmed with our build partner.

If you have any questions or concerns about any of the Kāinga Ora sites, please get in touch via email or contact phone below and ask to speak to a Community Development & Engagement Co-ordinator or a Stakeholder Relationship Manager in the Central East Auckland Team.

For wider Roskill Development queries, please contact info@roskilldevelopment.co.nz or visit www.roskilldevelopment.co.nz

Nāku iti noa, noa

Community Engagement and Partnerships Team

Central East Auckland

Freephone: 0800 801 601

Email: centraleastakl.region@kaingaora.govt.nz



Roskill Development
PUT YOURSELF IN THE CENTRE



Kāinga Ora
Homes and Communities

Figure 1: Site Plan

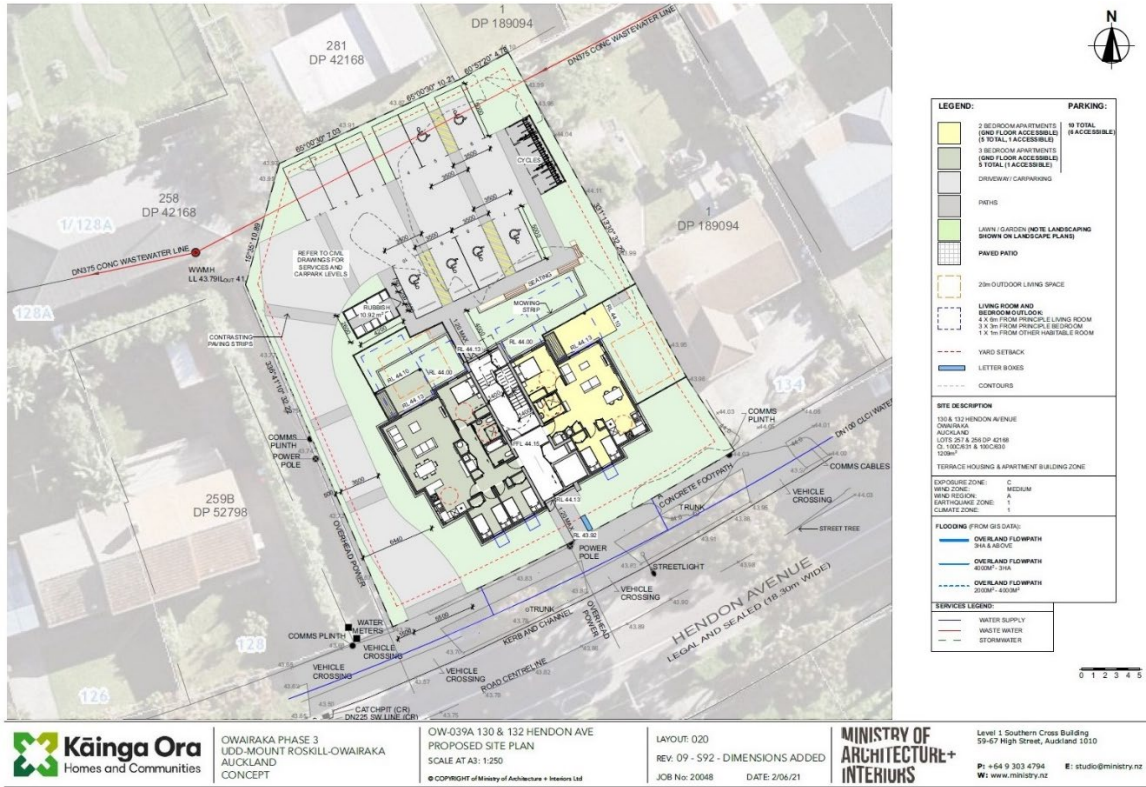

Figure 2: Landscape Plan

